

## Quick Start Guide

### Indoor/Outdoor Home Security Wi-Fi Camera

#### Setup Video

Scan QR code or visit  
<https://www.tp-link.com/support/setup-video/#cloud-cameras>



7100000061 REV1.2.0

\*Images may differ from your actual product.

## 01 / Set Up Your Camera

1. Firmly **plug** the USB cable into the camera's type-C port, and connect it to a power outlet.

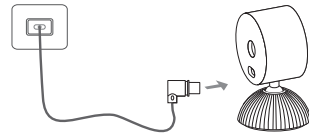

2. Download the **Tapo** app from the App Store or Google Play, then log in.



OR



3. Tap the **+** button in the app and select your model. Follow the app instructions to complete setup.

## 02 / Adjust Camera Angle

Loosen the bracket and adjust the shaft to your preferred angle. **Tighten** the bracket to secure it.

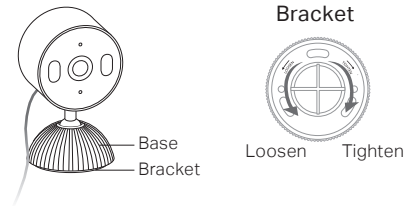

## 03 / Mount Your Camera

### Option 1. Mount to the Ceiling

#### 1. Drill Holes

Stick the mounting template sticker to the desired mounting place. Drill two holes according to the template.



#### 2. Unscrew the Bracket

Unscrew the bracket from the base.

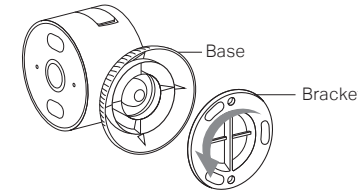

#### 3. Secure the Bracket

Insert two anchors into the holes and use the screws to affix the bracket over the anchors.

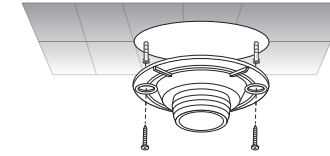

#### 4. Install the Camera

Screw the camera with the base onto the bracket. Loosen the base to adjust the angle, then tighten to secure.

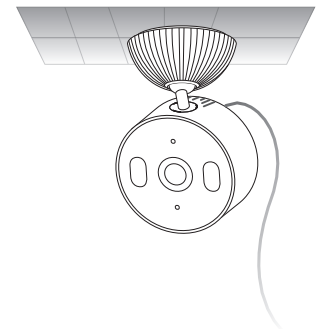

### Option 2. Mount to the Wall

#### 1. Remove the Camera

Avoid pulling the camera straight along the shaft. Instead, tilt and lift it at an angle for easier removal.

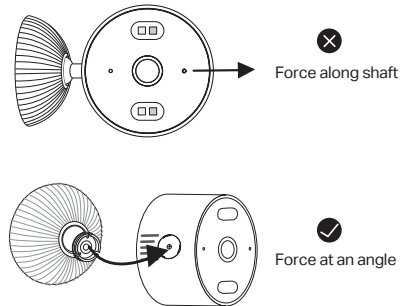

#### 2. Install Over the Back Mounting Hole

Make sure the bracket is secured to the base. Push the shaft into the back mounting hole until it clicks into place.

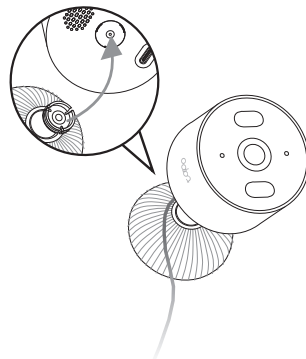

#### 3. Unscrew the Bracket

Unscrew the bracket from the base.

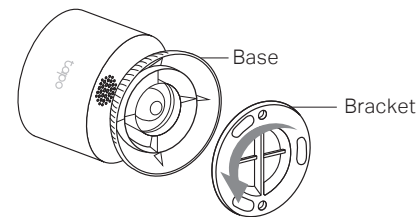

#### 4. Drill Holes

Stick the mounting template sticker to the desired mounting place. Drill two holes according to the template.

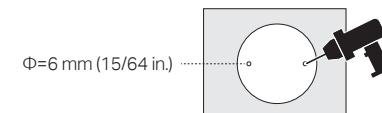

#### 5. Secure the Bracket

Insert two anchors into the holes and use the screws to affix the bracket over the anchors.

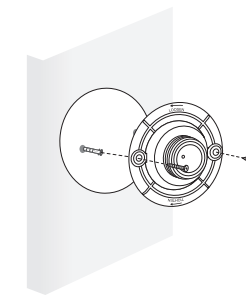

#### 6. Install the Camera

Screw the camera with the base onto the bracket. Loosen the base to adjust the angle, then tighten to secure.

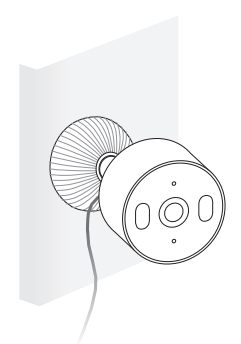

04 / Organize the Cable

Run the cable along the wall and fix it with the provided cable clips. Here's how:

- 1) Drill one hole using the electric drill [6 mm (15/64 in.) Drill Bit], insert an anchor, then use a screw to affix the cable clip over the anchor.
- 2) Repeat the above steps to organize the cable.

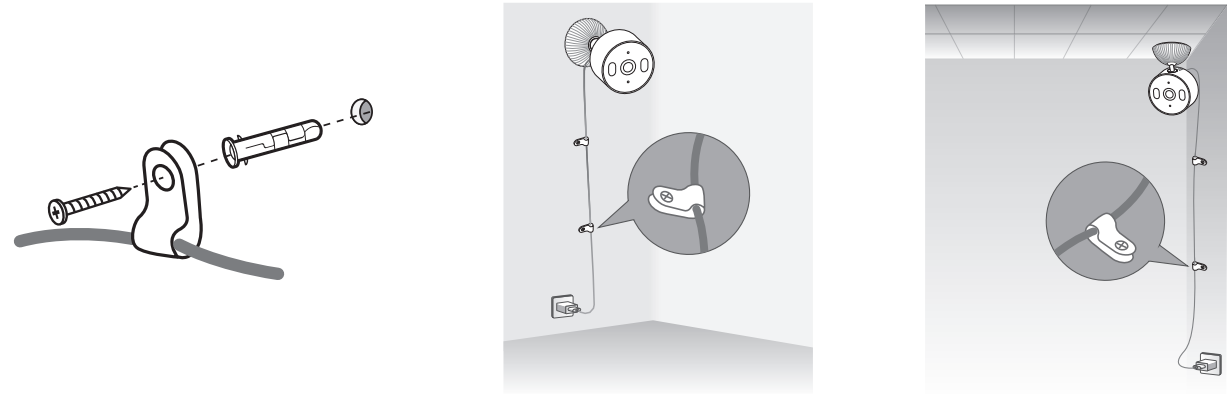

System LED Indications

|                        |                        |
|------------------------|------------------------|
| Solid red              | Starting up            |
| Blinking red and green | Ready for setup        |
| Blinking red slowly    | Connecting to Wi-Fi    |
| Solid amber            | Connected to Wi-Fi     |
| Solid green            | Connected to the cloud |
| Blinking red quickly   | Camera resetting       |
| Blinking green quickly | Camera updating        |

Safety Information

- Do not use damaged charger or USB cable to charge the device.
- Do not use any other chargers than those recommended.
- Do not use the device where wireless devices are not allowed.
- Adapter shall be easily accessible.
- Use only power supplies which are provided by manufacturer and in the original packing of this product. If you have any questions, please don't hesitate to contact us.
- Keep the device away from fire or hot environments. DO NOT immerse in water or any other liquid.
- Do not disassemble, repair or modify the product.
- Do not use the product if the casing has been broken. Danger of electric shock.
- Never touch the product with wet hands.
- Do not place near automatically controlled devices such as fire alarms. Radio waves emitted from this product may cause such devices to malfunction resulting in an accident.
- Observe restrictions on using wireless products in fuel depots, chemical plants or when blasting operations are in progress.
- Do not use liquid to clean the product. Only use a dry cloth.
- Never put metal objects inside the product. If a metal object enters the product, turn off the circuit breaker and contact an authorised electrician.
- This product is not intended to be used when providing medical care. Consult the manufacturer of any personal medical devices, such as pacemakers or hearing aids to determine if they are adequality shielded from external RF (radio frequency) energy.
- Do not use this product in health care facilities. Hospitals or health care facilities may be using equipment that could be sensitive to external RF energy.
- Do not place heavy objects on top of the product.
- When you leave the product unused for a long time unplug the product from the power outlet.
- This product may interfere with other electronic products such as TV, radios, personal computers, phones or other wireless devices.
- Adapter should be used indoors where the ambient temperature is lower than or equal to 40 °C.
- Operating Temperature: -20 °C ~ 45 °C (-4 °F ~ 113 °F)
- The camera shall be installed no higher than 2 meters.

Appearance

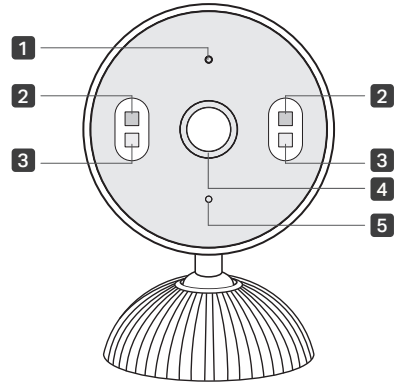

- 1 System LED
- 2 White Lights
- 3 IR Lights
- 4 Lens
- 5 Microphone

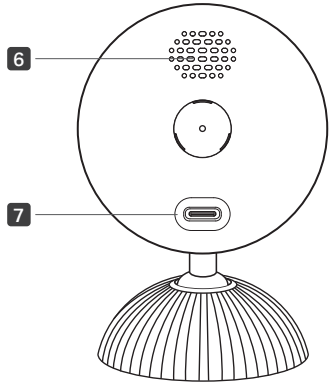

- 6 Speaker
- 7 USB Type-C Power Port

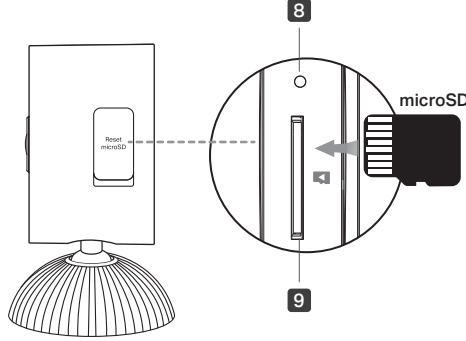

- 8 Reset Button
  - Use a pin to press and hold for 5s: Reset Wi-Fi settings
  - Use a pin to press and hold for 10s: Reset to factory settings
- 9 microSD Card Slot
  - Open the cover. Insert a microSD card (not included) and initialize it on the Tapo app for local recording.

TP-Link hereby declares that the device is in compliance with the essential requirements and other relevant provisions of directives 2014/53/EU, 2009/125/EC, 2011/65/EU and (EU)2015/863. The original EU declaration of conformity may be found at <https://www.tapo.com/support/ce>

TP-Link hereby declares that the device is in compliance with the essential requirements and other relevant provisions of the Radio Equipment Regulations 2017. The original UK declaration of conformity may be found at <https://www.tapo.com/support/ukca/>



©2025 TP-Link

?

Need some help?

Visit <https://www.tapo.com/support/> for technical support, user guides, FAQs, warranty & more

